

KEY FEATURES

- Induction hardened ‘V’ rails ensure accuracy and durability
- Ball-screw feed
- Hand & auto feed to main axis
- Direct drive ISO 40 spindle
- Choice of Pneumatic and Hydraulic versions
- Designed to suit a variety of mounting options, including bolting, switch magnets, chain clamps and gantry assemblies.

DESCRIPTION

The MR range of milling rails are built for rigidity and precision. Each machine is designed to carry out a wide range of general purpose in-situ milling applications.

APPLICATIONS

MR milling rails are incredibly versatile. Common on-site machining applications include: heat exchangers, pump and motor pads, steel mill stands, ship building, turbine split lines and many more.

SPECIFICATIONS

	MR1000	MR1500	MR2000	MR3000
Max Stroke (X main axis)	1000mm (40")	1500mm (60")	2000mm (78.7")	3000mm (118")
Max cutter diameter (with adaptation at extra cost)	200mm (8")	200mm (8")	200mm (8")	200mm (8")
Hand Feed	10mm/rev (0.394"/rev)	10mm/rev (0.394"/rev)	10mm/rev (0.394"/rev)	10mm/rev (0.394"/rev)
Auto Feed	0 - 83mm/min 0 - 3.25"/min	0 - 83mm/min 0 - 3.25"/min	0 - 83mm/min 0 - 3.25"/min	0 - 83mm/min 0 - 3.25"/min
Spindle Type	ISO 40	ISO 40	ISO 40	ISO 40
Spindle R.P.M Min/Max (Standard supply)	50 - 640	50 - 640	50 - 640	50 - 640
Min spindle down feed	80mm (3.14")	80mm (3.14")	80mm (3.14")	80mm (3.14")
Spindle Motor (Hydraulic)	5.0 Hp (3.7 kw)	5.0 Hp (3.7 kw)	5.0 Hp (3.7 kw)	5.0 Hp (3.7 kw)
Spindle Motor (Pneumatic @ 90psi)	4.0 Hp (3.0 Kw)	4.0 Hp (3.0 Kw)	4.0 Hp (3.0 Kw)	4.0 Hp (3.0 Kw)
Feed Motor (Hydraulic)	2.2 Hp (1.64 Kw)	2.2 Hp (1.64 Kw)	2.2 Hp (1.64 Kw)	2.2 Hp (1.64 Kw)
Feed Motor (Pneumatic @ 90psi)	1.5 Hp (1.11 Kw)	1.5 Hp (1.11 Kw)	1.5 Hp (1.11 Kw)	1.5 Hp (1.11 Kw)
Pneumatic Air consumption / supply needed	98 scfm (2.69 m3/m)	98 scfm (2.69 m3/m)	98 scfm (2.69 m3/m)	98 scfm (2.69 m3/m)
Hydraulic Supply needed	70L/min (18gal/min)	70L/min (18gal/min)	70L/min (18gal/min)	70L/min (18gal/min)

INCLUDED AS STANDARD WITH MACHINE

The machine is supplied complete with the following items;

- ✓ Maintenance Toolkit
- ✓ Air filter lubricator
- ✓ Hose connection
- ✓ Storage / shipping box
- ✓ CE certificate
- ✓ Packing list and manual

SET UP AND OPERATION

The operator must be:

- Trained and conversant with the product
- Able to identify the correct and incorrect use of static or portable machines.
- Comply with all local and internationally recognised regulations regarding safe use of powered machines.

SHIPPING WEIGHTS

Machine name	kg	lbs
MR1000	306 kg	675 lbs
MR1500	374 kg	825 lbs
MR2000	440 kg	970 lbs
MR3000	470 kg	1036 lbs

SHIPPING DIMENSIONS

	Length	Width	Height
MR1000	189cm (74")	94cm (37")	62cm (24")
MR1500	230cm (91")	65cm (26")	56cm (22")
MR2000	280cm (110")	65cm (26")	56cm (22")
MR3000	385cm (152")	65cm (26")	56cm (22")

All weights and dimensions approximate and for guidance only.

IMPORTANT
PLEASE REVIEW OPTIONS, ACCESSORIES
AND SPARE PARTS ON NEXT PAGES



MR MILLING MACHINE OPTIONS & ACCESSORIES

HYDRAULIC POWER PACK

Part number:

- PP3-C-E** Electric motor
- PP3-S-D** Diesel motor



HYDRAULIC CONTROL PANEL

Part number: HDCP-6

Control panel for use with the MR range of milling machines

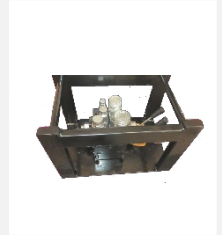

CHAIN CLAMP

Part number: MR1500-9

Please specify pipe diameter and size of milling rail when you enquire

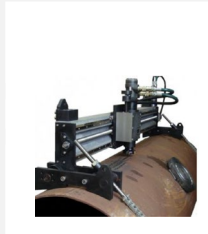

SWITCH MAGNETS

Switch Magnets for use with MR Milling Rails.

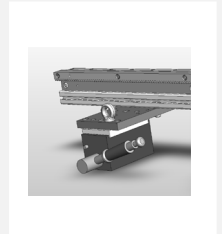

GANTRY FRAMES

Widen the working envelope to suit your project. Available as rack feed and ball screw options.

